

WESTERN SYDNEY
UNIVERSITY



LEADENGAGE ASPIREDEVELOP

LEAD Conference Program 2019

THE LEAD CONFERENCE 2019 LEADING WITHOUT A TITLE

If you could change the world would you?

“Leadership 2.0”, “lateral leadership”, “the democratisation of leadership” – leading without a title goes by many names. It looks at a leadership approach that exerts influence without authority and causes valuable, positive change in the way we approach problems and innovate. In its essence, it is the power of individuals to harness the abilities of everyone involved by creatively shifting the way we think about the world, our organisational impact, the industry we work in, our communities or ourselves.

Change permeates today’s business environment and society. We see emerging and aspiring leaders who want to transform the lives of others, and to lead with confidence in an increasingly complex world. To drive change, everyone has to be accountable, whether that’s part of your job, political ideations or a social movement every shareholder has to show leadership in the work they do. In leading without a title you can pave the way for such change by fostering specific traits focusing on collaboration, open communication and power-sharing which helps them to enforce positive change.

This conference is about preparing yourself in today’s volatile world to affect real change in your life, the way you think, your university, communities and beyond, without a title. Pick up some ideas and insights on the concept of creative problem solving, finding your authentic voice, leading through change, confidently navigating networking, influencing others and having an open mindset – then take these skills and apply them to situations or problems that need a leader.

Explore how YOU can LEAD and how you can create other leaders in your wake!

PROGRAM MONDAY 29 APRIL 2019

TIME	SESSION	PRESENTER	LOCATION
8:00am – 9:00am	Registration Pick up your conference pack and confirm your timeslot for a free professional profile photograph. Network with your peers over tea and coffee.		Rydges Hotel Lobby
9:00am – 9:30am	Introduction Conference Co-Chairs	Dzenita Semic & Nicole Brackenreg	Triple Crown Ballroom
	Welcome to Country	Community Elder and Gadigal Elder	Triple Crown Ballroom
	Official Opening Executive Director, Student Services	Ellen Brackenreg	Triple Crown Ballroom
9:30am – 10:40am	KEYNOTE ADDRESS I am a leader. As leaders, our challenge is to create belonging. How we engage and influence others ultimately determines our effectiveness and our ability to leverage outcomes. The fastest path to shaping a team and organisation is to be your authentic self and approach others with a sense of curiosity. Sam will discuss what authentic leadership looks and feels like, with some real life examples to illustrate the impact of authenticity on inclusivity, collaboration and self-accountability. Authentic leadership transcends titles, looking at how you can bring your whole self to a scenario that needs a leader.	Sam Turner Founder & Managing Director Sam Turner Inclusion	Triple Crown Ballroom
10:40am – 11:05am	MORNING TEA		FOYER
11:05am – 12:10pm	SESSION 1 Choose one of these six sessions to attend:		
	I am Authentic Great stories inspire action. In this interactive workshop you will explore how to build and communicate your authentic narrative, allowing you to communicate your values, strengths, skills and passions. Magnify your voice with LinkedIn, the leading professional and personal branding network and discover how to share your authentic voice with confidence.	Danielle Redford Smith LinkedIn	Ground Floor Ballroom A
	I am Resilient Large-scale challenges require leaders to be more innovative, more bold, more strategic, and more resilient. Resilience is often overlooked, but can help leaders avoid being drained, daunted, and exhausted. How do you take that feedback or result and move forward? Explore the resilience donut to identify and combine strengths you need to thrive in the modern world.	Kylie Warry The Resilience Centre	Ground Floor Ballroom B
	I am an Influencer Being able to positively influence others is a must, but it is not as easy as waving a magic wand, or manipulating others to get what you need. Influence comes from trust. Together we will uncover the psychology of influence and provide you with key principles to connect with others. Learn to lead through your attitude - is yours worth catching?	Veronica De Paoli Manager, Major Projects Western Sydney University	Ground Floor Ballroom C

PROGRAM

MONDAY 29 APRIL 2019

TIME	SESSION	PRESENTER	LOCATION
11:05am – 12:10pm	I am Confident Have you ever struggled to make a decision? How should I provide this feedback? What job should I pursue? Chris will help you navigate the complexities of decision making with confidence by considering, honouring and articulating your values. Map out your personal values so you have the confidence to seek opportunities in alignment to these values.	Chris Hall CEO Be What You Want	Mezzanine Phar Lap
	I am a Networker Have you hung back on introducing yourself to strangers? Or not known what to say, how to relate or how to escape? Face-to-face networking can be fraught with danger. Networking isn't about being the most energetic or charismatic person in the room, it's about communicating value quickly and being responsive to different situations and people.	Kelly-Anne Cummings Work Life Balance Academy	Ground Floor Steeds
	I am Creative Being able to think creatively is a crucial skill for all leaders. The good news is, it can be learned. Dean will break down the 'magic' of creative thinking lifting the veil on the creative problem-solving process using real-world examples. Learn how to generate creative ideas, implement them, inspire creativity in peers, and build your confidence to lead with creativity.	Dean Worland Experience Manager Semi-Permanent	Sixth Floor Strawberry Road
12:10pm – 12:20pm	COMFORT BREAK		FOYER
12:20pm – 1:20pm	MAIN SESSION Are. You. Ready? Hurtling down a mountain at over 100km/ hour there is no greater skill required than trust. It's a critical element to Jessica's success as a summer and winter Paralympic medallist, Osteopath and Board Director. Success as a vision impaired athlete is underpinned by the guides that support her to compete, not unlike an individual working within a team. The ever changing dynamic of leadership and team work in the most extreme of environments, where high speed makes the risk real and profound, mnakes it critical they get it right. In this address Jessica will share how she develops, builds and sustains trust, team work and leadership whilst adapting to the ever changing dynamics around her.	Dr Jessica Gallagher Summer and Winter Paralympic Medallist	Triple Crown Ballroom
1:20pm – 2:15pm	LUNCH		FOYER
2:15pm – 3:20pm	SESSION 2 Choose one of these six sessions to attend:		
	I am Authentic Great stories inspire action. In this interactive workshop you will explore how to build and communicate your authentic narrative, allowing you to communicate your values, strengths, skills and passions. Magnify your voice with LinkedIn, the leading professional and personal branding network and discover how to share your authentic voice with confidence.	Danielle Redford Smith LinkedIn	Ground Floor Ballroom A
	I am Resilient Large-scale challenges require leaders to be more innovative, more bold, more strategic, and more resilient. Resilience is often overlooked, but can help leaders avoid being drained, daunted, and exhausted. How do you take that feedback or result and move forward? Explore the resilience donut to identify and combine strengths you need to thrive in the modern world.	Kylie Warry The Resilience Centre	Ground Floor Ballroom B

TIME	SESSION	PRESENTER	LOCATION
2:15pm – 3:20pm	I am an Influencer Being able to positively influence others is a must, but it is not as easy as waving a magic wand, or manipulating others to get what you need. Influence comes from trust. Together we will uncover the psychology of influence and provide you with key principles to connect with others. Learn to lead through your attitude - is yours worth catching?	Veronica De Paoli Manager, Major Projects Western Sydney University	Ground Floor Ballroom C
	I am Confident Have you ever struggled to make a decision? How should I provide this feedback? What job should I pursue? Chris will help you navigate the complexities of decision making with confidence by considering, honouring and articulating your values. Map out your personal values so you have the confidence seek opportunities in alignment to these values.	Chris Hall CEO Be What You Want	Mezzanine Phar Lap
	I am a Networker Have you hung back on introducing yourself to strangers? Or not known what to say, how to relate or how to escape? Face-to-face networking can be fraught with danger. Networking isn't about being the most energetic or charismatic person in the room, it's about communicating value quickly and being responsive to different situations and people.	Kelly-Anne Cummings Work Life Balance Academy	Ground Floor Steeds
	I am Creative Being able to think creatively is a crucial skill for all leaders. The good news is, it can be learned. Dean will break down the 'magic' of creative thinking lifting the veil on the creative problem-solving process using real-world examples. Learn how to generate creative ideas, implement them, inspire creativity in peers, and build your confidence to lead with creativity.	Dean Worland Experience Manager Semi-Permanent	Sixth Floor Strawberry Road
3:20pm – 3:40pm	COMFORT BREAK		FOYER
3:40pm – 4:40pm	Future Focus Alumni Panel. Featuring distinguished panellists discussing the future of work, leadership and all your other burning questions.	Dzenita Semic	Triple Crown Ballroom
4:40pm – 4:45pm	Closing Remarks	Dzentia Semic & Nicole Brackenreg	Triple Crown Ballroom Foyer
4:45pm – 5:45pm	NETWORKING EVENT		
5:45pm	FINISH		

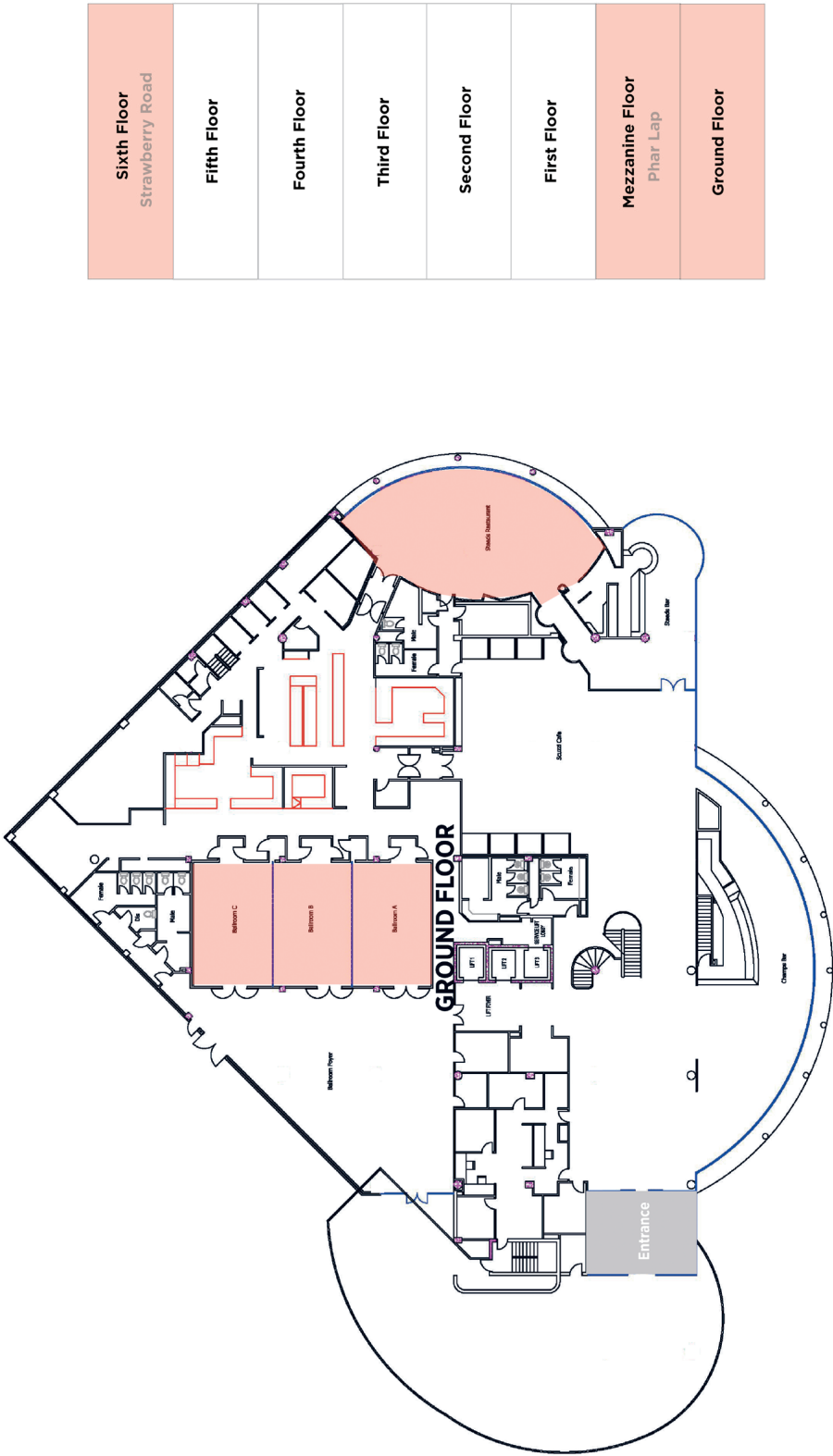

Keynote Speaker



SAM TURNER
Founder and Managing Director
Sam Turner Inclusion

Sam Turner is the former Head of Inclusion & Diversity for the Westpac Group, and a much sought after speaker for her thought leadership on creating inclusive workplaces.

She is an energetic and engaging leader who is passionate about people, and equality.

Sam was with Westpac for five years including a role as Business Manager for NSW Regional Banking, and has held various senior roles at NAB, BHP, and Deloitte.

Sam was the Overall Winner of the 2016 Women of Influence Awards, and was named one of Australia's Outstanding 50 LGBTQ leaders in the Deloitte/Google 2018 list. Sam has recently been granted a prestigious Churchill Fellowship to undertake global research to enable greater Cultural Diversity in Australian leadership.

Sam is also the Chair of The Aurora Group, a not for profit organisation providing grants to LGBTQ charities.

She holds an Honours degree in Commerce, and a Postgraduate Diploma of Psychology.

Main Session



DR JESSICA GALLAGHER
Summer and Winter Paralympic Medalist
Board Director Vision 2020 Australia Osteopath

Recently profiled as one of 200 women who will change the way you see the world.

Jessica's sporting credentials as the first Australian to have medalled at a summer and winter Paralympics speaks for itself but it's her ability to bring the authenticity of her unique life experiences both in business and on the sporting field and create synergy with her audience that is un-paralleled.

Jessica is an Osteopath in private practice, Board Director and global ambassador for Vision 2020 Australia and ambassador for Vision Australia and Seeing Eye Dogs Australia and a high performance athlete in the sporting world.

As an Australian representative in 3 sports (athletics, alpine skiing and track cycling), the first Australian to have medalled at a summer and winter Paralympics, the first Australian women to medal at a winter Paralympics, a World Champion and numerous World Championship and World Cup medals all with a slight twist.

Have you ever wondered what it would be like to ski down a mountain at 100km/hr? Or to ride on a tandem bike you can't control at 68km/hour? How you might do this when you're vision impaired and being instructed by someone else acting as your eye sight? Would you have the courage to trust someone when they literally take your life into their hands?

Jessica's experiences will challenge you to think differently and see your world from a whole new perspective.

Her inspiring story is unlike any other.

Facilitators

DANIELLE REDFORD-SMITH

Customer Success Manager
LinkedIn

As a LinkedIn Customer Success Manager, Danielle helps transform the ways that professionals and executives cultivate a culture of learning. During her tenure at LinkedIn Sydney, Danielle has worked with a wide range of academic, corporate and government organisations to ensure they maximise their LinkedIn enterprise tools by sharing best practices, recommended workflows, learning content and data insights. She empowers customers to become more productive and successful.

Danielle holds a Bachelor of Psychological Science majoring in Criminology and has leveraged off her exceptional understanding of human behaviour throughout her career. In her previous role at Nearmap, during a time of rapid technological growth, Danielle first paired her passions for helping clients and colleagues with her love of technology as she engaged with a breadth of programs. Working on the “front lines” with two innovative technology companies means Danielle has come to love empowering others to do more with their technology, embedding the growth mindset and embracing learning and change in all endeavours.

KYLIE WARRY

Lead Trainer
The Resilience Centre

Kylie has worked with the Resilience centre for 10 years; focusing on communication and how this affects key attributes such as leadership, team dynamics, relationships and productivity within a team. Kylie is passionate about the Resilience Doughnut model and believes it is an invaluable and fresh tool to teach us something new, simple and highly relevant to our everyday relationships, work and life.

Kylie has shared this model extensively with teams, schools and businesses to develop overall resilience in a personal, corporate and team setting. Kylie believes the Resilience Doughnut is an invaluable support for building personal and professional resilience. Kylie is the Lead Trainer with Teamology, a training organisation based in Sydney. Her previous roles have been as Rehabilitation Manager, managing teams of rehabilitation professionals in Injury Management.

Kylie is also the author of The Enlightened Communicator and is a member of ASORC.

VERONICA DE PAOLI

Manager, Major Projects (HR)
Western Sydney University

As the manager of the University’s “Our People – Securing Success” project implementation, Veronica helps transform the way that professionals and academics cultivate a dynamic and innovative culture. Her substantive position at Western is the School Manager of Education which pairs her passion for leadership and strategy as she manages an operational team of professional staff across multiple business portfolios. Having started her career as a project accountant and transitioned into learning & development then business advisory, Veronica is now an experienced and innovative Higher Education leader with over 15 years’ experience in professional services.

Veronica has a demonstrated capacity for building strategic, productive relationships and providing effective commercialisation advice across a broad range of industries. Veronica is a Master’s qualified executive coach with undergraduate qualifications in accounting and project management. She has excellent interpersonal, negotiation and problem solving skills resulting in building effective team performance, successful high-end project delivery and valuable industry and government collaboration

CHRIS HALL

CEO
Be What You Want

Chris Hall is a successful Speaker, Coach, and Gallup Strengths Facilitator, based out of Sydney.

Having worked with leading businesses around the globe, Chris has become an expert in how to enhance Happiness, Resilience, and the application of Strengths in the workplace. Chris uses the Gallup Strength methodology to tap into the potential of both individuals and teams, delivering events to both corporate and educational institutions.

His coaching style is a fusion of the best schools of thought, enabling his clients to access new levels of integrity, fulfilment, and productivity.

KELLY-ANNE CUMMINGS

Mindset Coach
Work Life Balance Academy

Kelly has 10 years’ experience leading and managing Work Life Balance Academy, a Coaching Practice and Mindset Training Organisation in Western Sydney. Kelly’s ‘normal’ consists of helping hundreds of Executives, Business Owners and Leaders to become more productive and intentionally build a culture of balance in both their workplaces and homes.

Work Life Balance Academy has worked on the “front lines” with businesses and employees across a breadth of sectors to help master the art of communication and motivation. Kelly uses the DISC model to uncover behaviour within individuals and teams, this provides a guideline to allow people to understand their differences, and leverage their similarities to communicate effectively across contexts. Kelly’s practical experience of networking and authentic communication style, has enabled her to transition from a working professional to entrepreneur and leadership facilitator.

DEAN WORLAND

Experience Manager
Semi Permanent

As part of Semi Permanent’s experience team, Dean helps organise the talented line-up for the Sydney event each year. His role is to maximise the speakers’ on-stage presentation and work with them to produce side events to supplement the main event.

Dean’s background is in producing events within the corporate sphere, focusing on the MICE (meetings, incentives, conferences, exhibitions) industry and customer experience. He has produced events across the world including in New York, London, and Sydney, working with Clients such as Samsung, the British Fashion Council, Uno Home Loans, and Ernst & Young.

Before upskilling in UX/CX, Dean spent the first decade of his career working as an event producer and manager with some of Australia’s best hospitality brands, including Luke Mangan, Broadsheet, and The Westin. He’s always been passionate and dedicated to improving how people interact with a product or service.

Dean believes in applying design principles to make the entire user journey during an event as efficient and enjoyable as possible.

Alumni Panel

AMMAR KHAN

Bachelor of Housing (2008)

Managing Director at Urban Estate Developments, Urban Estate Constructions and Urban Estate Investments.

Ammar Khan had already been working in and around property development and real estate management before undertaking a Bachelor of Housing degree at Western Sydney University. After graduating in 2008, he has become the owner and managing director of three separate companies – Urban Estate Constructions, Urban Estate Developments, and Urban Estate Investments. Collectively, he has made a successful career out of commercial, residential, and industrial construction, urban renewal and redevelopment, and property investment.

Throughout this time, Ammar has been a strong believer and advocate for transformative change in Western Sydney and his home in Mt Druitt. With visions of new infrastructure and employment for the area (including a return of the Wonderland theme park to Western Sydney), he has run as an independent candidate in the 2013 and 2016 federal elections in the Western Sydney seat of Chifley.

PROFESSOR IONA NOVAK

Doctor of Philosophy, 2009

Master of Science (Honours) Health, 2005

Board of Directors at Occupational Therapy Australia

Professor and Head of Research – Cerebral Palsy Alliance

Professor Iona Novak a formidable advocate for the people she has dedicated her professional life to helping – those living with cerebral palsy. This PhD alumna is the Head of Research at the Cerebral Palsy Alliance Research Institute based at the University of Sydney, a centre she helped found. From there, she has contributed significantly to the growth, reach and impact of the field. Partly inspired to work in health care by her grandmother’s experiences as a nurse in World War II, Iona learned at Western Sydney University how to build a career by thinking outside the box: “Have possibility as your framework rather than fear of failure.”

Iona’s 15-year clinical research career is full of collaborations that have enabled ‘firsts’ in the field: the first national Cerebral Palsy Register, the first Australia-US-Canada stem cell alliance that she established as a Fulbright Scholar, and the first Australian stem cell trial in the search for a cure for cerebral palsy. Her secret is a deep empathy she has for the people her work will ultimately benefit. “They set the research agenda”, she says. “If you listen to your patients, you will understand what matters to them – it’s amazing how much progress you can make.”

JOHN REFALO

Bachelor of Business (Accounting) (2006)

Senior Manager at Mackay Goodwin

John attended Western Sydney University from 2003 until 2006, graduating with a Bachelor of Business (Accounting) degree. Since then, he has built an impressive career around insolvency accounting. He has worked variously at boutique to mid-tier accounting firms with a stint in finance. John has accumulated a wealth of experience across numerous industries, including entertainment, hospitality, security, education, information technology, management, and construction.

During that time, John has been an active participant in the small business community and has completed the Chartered Accountants Program with the Chartered Accountants of Australia and New Zealand, as well as the Insolvency Education Program with the Australian Restructuring Insolvency and Turnaround Association (ARITA).

John is now a Senior Manager at Mackay Goodwin, one of Australia’s leading Insolvency firms which specialises in corporate insolvency through restructure and turnaround, corporate advisory, liquidation, and receivership. John is passionate about helping businesses of all sizes navigate their way through financial distress when facing change.

EMILY MCCAMMON

Bachelor of Arts, Communication (Dean’s Scholar) (2017)

National Publicity Coordinator at Paramount Pictures

Emily attended Western Sydney University from 2014 to 2017, graduating with a Bachelor of Communication (Dean’s Scholars) with Distinction. Throughout her studies, she truly discovered her eye for all things PR, and was able to gain valuable experience that would guide her into her chosen career path, including internships at MAXMEDIALAB and Taronga Zoo.

Her drive in the field of PR has led her to her current position in the National Publicity team at Paramount Pictures, where she is involved in major event planning, media & studio liaison and activations to place the films in front of the right audiences.

Her passion for wildlife conservation has also driven her to become involved in The Australian Rhino Project, where she coordinates the social media pages on a volunteer basis.

The LEAD team would like to thank the following organisations and university units for their donations and support in bringing the LEAD conference to Western Sydney University students.

INTERNAL

Alumni

MATES

PASS

Program’s Unit

Student Representation and Participation

The Academy

EXTERNAL

Grill’d

Rydges Parramatta

Semi Permanent

Sittanos Bar and Restaurant

Western Unlimited

Work Life Balance Academy



All information is correct at time of printing, and subject to change.

Western Sydney University
Locked Bag 1797
Penrith NSW 2751 Australia



[WESTERNSYDNEY.EDU.AU/LEAD](https://westernsydney.edu.au/lead)